

MUSKOGEE COUNTY GENEALOGICAL SOCIETY

801 WEST OKMULGEE

MUSKOGEE, OKLAHOMA 74401

VOLUME 9 NO. 3

DECEMBER 1992

OFFICERS

CLEO SHAMBLINPRESIDENT
CLISTA NICHOLSON ANDERSONVICE-PRESIDENT
MARY McLAIN DOWNINGSECRETARY
JEAN VANNTREASURER
MICKEY HOOPER HAGANPRIOR-PRESIDENT
MORRIS W. YOUNGBLOODMEMBER-AT-LARGE
PHIL PORTERMEMBER-AT-LARGE
SHIRLEY SHOCKLEY GRIFFITHMEMBER-AT-LARGE
DEBRA SUE HALL SHAMBLINEDITOR

MEETINGS: Society meetings are held on the 4th Thursday of each month at 7 p.m. in the Muskogee Public Library, 801 West Okmulgee, Muskogee , Ok.

BOOK REVIEWS: Reviews of donated books and materials will receive mention in the Quarterly and society meetings, there-after, they will be housed in the Grant Foreman room of the Muskogee Public Library for public use.

CONTRIBUTIONS: Articles and contributions for the Quarterly should be sent to the above mailing address. All information concerning Muskogee County area families will be edited and published according to the editor's discretion. Contributor's name and address will be printed.

NOTICE TO NEW MEMBERS: Those who join during any month of the year after the membership month of May, will receive all Quarterlies that have been published that year.

M.C.G.S. QUARTERLY: The quarterly will be published four times a year, JUNE, SEPTEMBER, DECEMBER, AND MARCH. Queries are free to members; \$1.00 for non-members. Back issues are available at \$2.00 each, plus \$1.00 for postage.

THE MUSKOGEE COUNTY GENEALOGICAL SOCIETY AND ITS BOARD OF DIRECTORS DOES NOT ASSUME RESPONSIBILITY FOR ERRORS OF FACT OR JUDGEMENT ON THE PART OF THE CONTRIBUTORS.

ASSISTANT EDITOR: VIRGINIA VANN PERRY

TABLE OF CONTENTS
VOL. 9 NO. 3

<u>TITLE</u>	<u>PAGE</u>
President's Letter.....	39
DAVID ANSON ROGERS MEMORIAL.....	40
WILLIAM W. FINK.....	41
NEW MEMBERS.....	42
1912 MUSKOGEE COUNTY SCHOOL CENSUS HASKELL OK.....	43
GRITTS, OK.....	50
GRID MAP OF GRITTS OK before 1910.....	51
SCALE MAP OF GRITTS 1929.....	52
ACCIDENTAL DEATHS.....	53
SEEKING BURIAL PLACES OF VETERANS.....	54
NANCY C. GOFF ANCESTOR CHART.....	55
BARBARA DRAKE RITTER ANCESTOR CHART.....	56
NEW TITLES.....	57
PUBLICATIONS FOR SALE.....	60

Letter from the President

1992 is soon to be 'Past History' which puts it in the field of our interest. That interest is obvious from the programs presented throughout the year.

Listed are some of the programs offered this year.

Scot-Irish ancestry.

Searching the Census.

Using the Genealogical Helper.

Often over looked resources.

Using the LDS Library.

If you missed any of those programs, it was your loss.

Our Fall Workshop was a real success. The Syllabus alone was worth the fee charged to attend.

I'll take this opportunity to thank you, the members and your Board and Officers for making this a successful year.

Your President

Clayton J. Shambler

VETERAN DIES

D. A. Rogers, Who Heard Lincoln-Douglas Debate, Was Pioneer of City



D.A. Rogers

David Anson Rogers, 87, witness to historic episodes preceding and during the Civil war and a resident of Muskogee for more than 20 years, died at a hospital here early yesterday after an illness of about a week.

As a boy of 12 years, in October, 1858, he was more interested in a game of leap frog than in hearing Abraham Lincoln and Stephen A Douglas engage in one of the debates which is credited with having made Lincoln, rather than Douglas, the Civil war president.

Then as a boy of 16 years, he fought with the Union forces as a volunteer from Illinois in the operations against Vicksburg, Miss.

During his more than 20 years' residence in Muskogee, Mr. Rogers looked after the property interests of C. W. Raymond, former federal judge here and a resident during recent years of Watseka, Ill. Mr. Rogers and Judge Raymond were boyhood playmates.

Mr. Rogers was a native of Illinois, having been reared in Washington of that state. It was there during his boyhood that intersectional bitterness flamed at his highest, with the then Senator Stephen A. Douglas and Abraham Lincoln recognized as leaders of conflicting schools of thought as to the settlement of the slavery question.

It was in 1858 that the episodes credited by historians with having changed the course of national history were enacted. Douglas then was seeking reelection as United States senator from Illinois with Lincoln as his opponent, and they engaged in a series of seven joint debates on issues of the campaign.

One of the debates was held at Metamora, Ill., within 12 miles of Rogers' home, and he, then 12 years old, accompanied several grown persons to the scene. Rogers frequently told of the huge crowd which had assembled and of having noticed the sharp physical contrast between the short, chunky Douglas and the tall Lincoln.

Mr. Rogers related that he occasionally crowded toward the platform to listen to a few words of the debate, but admitted with amusement that he was more interested in a game of leap frog that boys had arranged outside the crowd.

(Continued - Veteran Dies)

As a boy of 12, Mr. Rogers told that he was a "Douglas democrat," but he became a sincere admirer of Lincoln and during later years, accumulated a sizeable collection of articles relating to him.

Douglas, at the time, was generally considered the victor in the debates as he was reelected to the senate. But Mr. Rogers recounted that history now agrees that in satisfying the Illinois electorate with his stand on the slavery issues, he so dissatisfied others of the free states as to pave the way for his defeat and Lincoln's election as president in 1860.

Following the outbreak of the war, Mr. Rogers enlisted with Company G, 6th Illinois infantry on June 2, 1862.

At that time, Union operations in the west centered in the effort to gain control of the Mississippi, in which Vicksburg was the key, so as to cut the Confederacy in two. The first move, commanded by Admiral Farragut, occupied the summer and part of the autumn of 1862 and Mr. Rogers was a participant throughout. The movement, though unsuccessful, was followed by a second siege which resulted in the surrender of Vicksburg on July 4 and perhaps the hardest of the early blows of the war suffered by the Confederacy.

Rogers completed his term of enlistment in October, 1862 and was discharged.

During the years that followed until the time of his removal, Rogers engaged in railroad work, serving as agent at various points in Illinois.

During his residence here, he had made his home in an apartment in the Harris building, one of the holdings of Judge Raymond.

Mr. Rogers is survived by a sister in Fairbury, Ill. and by a nephew.

Muskogee Daily Phoenix, December 18, 1932, p. 2.

CIVIL WAR VETERAN, 85 DIES IN HOSPITAL HERE

William W. Fink Dies At Soldiers' Memorial.
Conduct Funeral Services This Afternoon

William W. Fink, 85 year old Civil war veteran of 907 South D street, died at the Veterans' bureau hospital here at 3:30 o'clock yesterday afternoon following a major operation.

Mr. Fink had been ill for the past two years. Recently the Veterans' bureau decided that veterans of the Civil war were entitled to treatment at bureau hospitals. Mr. Fink's condition became critical Sunday night, so he was taken to the government hospital and placed upon the operating table. he failed to rally from the operation.

Mr. Fink served under General Philip Sheridan during the Civil War with Company D of the 44th Illinois infantry.

He lived in Muskogee for the past 17 years, obtaining employment as a cabinet maker when he first came to this city. His wife died several years ago. He is survived by 3 sons.

Muskogee Weekly Phoenix, November 4, 1926, p. 7.

NEW MEMBERS

SEWELL, RAYMOND and JUNE. 2626 CALLAHAN, MUSKOGEE OK 74403

Researching: SEWELL, MO. 1864, TUCKER, ALA.,
WATSON, ALA/TEX.

HALL, JOE B., P. O. BOX 45, HULBERT OK 74441

Researching: HALL, LEE, WRIGHT.

MILLER, PAT, 2708 DAYTON, MUSKOGEE OK 74403

BURRIS, CAROL, 2311 MICHAEL ROAD, MUSKOGEE OK 74403-1832.

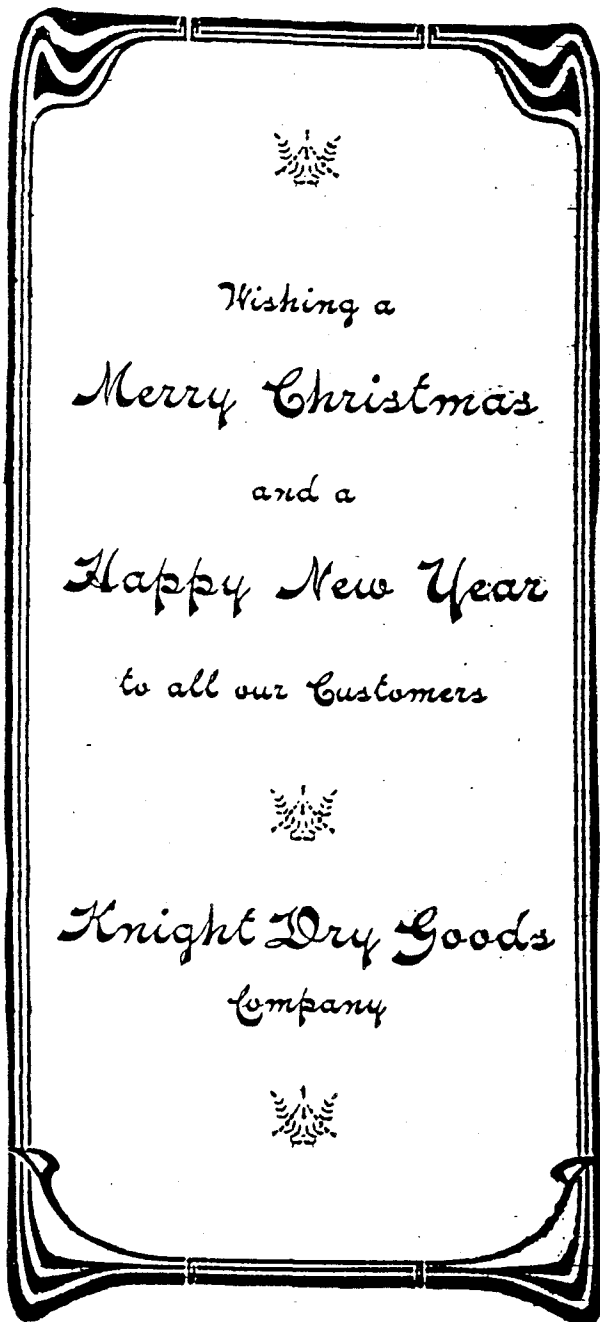

THE MUSKOGEE COUNTY
GENEALOGICAL SOCIETY
WISH ALL OF YOU A VERY
MERRY CHRISTMAS. HAVE
A HAPPY NEW YEAR.
WE WISH YOU LOTS OF
LUCK IN HUNTING FOR
YOUR RELATIVES.
THEY MAY BE HIDDEN NOW
BUT DON'T GIVE UP, THEY ARE
PROBABLY JUST WAITING
ON YOU AROUND THE CORNER.

NEW MEMBER

WORTEN, IRENE, P. O. BOX 754,
MUSKOGEE OK 74402.

Researching:

Thomas Henry BURGESS, Van-
Buren Ar, Robert Thornsberry
BURGESS 1858-1931, and Robert
Washington BURGESS.

con't from vol. 9 no. 2 page 33

1912 SCHOOL CENSUS

MUSKOGEE COUNTY

DISTRICT # 10 all were HASKELL OK residents.

Listed by parent, children, sex-if given, birthdate when given, and age if given.

1.	N. M. LAMBERTSON	Mahlon LAMBERTSON	M	May 5, 1899	13
		Event NEPTUNE			
2.	W. C. MITCHEL	Cecil MITCHEL	f	Jul 28, 1899	13
		Hazel "	f	Apr 20, 1901	11
3.	Darney DUSTON	Avid DUSTON	m	Jul 7, 1903	9
		Dessie "	f	Jul 18, 1905	7
4.	S. W. LOYD	Gladys LOYD	f	Nov 17, 1905	9
5.	R. T. OLSON	Odith OLSON	f	Jun 2, 1894	18
		Fritz "	m	Dec 24, 1898	15
		Giffenth "	m	Oct 22, 1900	12
		Harald "	m	Feb 9, 1903	9
6.	John LEWIS	Bill Nye LEWIS	m	Jul 25, 1898	14
		Glenn "	m	Sep 30, 1900	12
		Allen "	m	Oct 8, 1902	10
		Loyd "	m	Jan 8, 1905	7
7.	DILL BRASEL	Ola BRASEL	f	Aug 7, 1897	15
		Gladys "	f	Apr 19, 1904	8
8.	Mike McARTHUR	Eddie McARTHUR	m	Jan 22, 1900	12
		Paul "	m	Feb 6, 1902	10
		Daniel "	m	Feb 21, 1904	8
9.	A. J. ENGBERT	Eva ENGBERT	f	Apr 21, 1894	18
		Kate A. "	f	Aug 2, 1891	16
		Joe "	m	Jul 11, 1898	14
		Hurbert "	m	Apr 11, 1900	12
		Andrew "	m	Apr 15, 1902	10
		Lawrence "	m	May 9, 1904	8
10.	Eugene TODD	Ralf TODD	m	Dec 3, 1906	6
11.	H. F. TILLMAN	Erma TILLMAN	f	Aug 25,	18
		Warren "	m		17
12.	M. T. SMITH	Emma SMITH	f	Apr 7, 1905	7

13. Henry DEVERS	Selma DEVERS	f	May 15, 1896	16
	Cathrine "	f	Jul 18, 1898	14
	Olga "	f	Jul 18, 1900	12
	Mary "	f	Apr 16, 1902	10
	Anna "	f	Apr 16 1902	10
	Leo "	m	Mar 15, 1904	8
14. Henry-DEVERS	May "-		Jul	
15. L. LAMBERTSON	Vernon LAMBERTSON	m	Oct 16, 1902	10
16. A. C. DAVIS	Fred DAVIS	m	Feb 10, 1894	18
	Nada "	f	Mar 5, 1899	13
	Vergie "	f	Nov 6, 1901	11
	Claud "	m	Jul 19, 1904	8
17. Inez B. CULLOP	James CULLOP	m	Apr 22, 1894	18
18. I. N. LUNSFORD	Levia LUNGSFORD	f	Jul 25, 1896	16
	Winford "	m	Jul 3, 1902	10
19. Mrs. Maggie HOLPP	Myrtle HOLPP	f	Jul 27, 1896	16
	Minnie "	f	Nov 18, 1893	19
	Mary "	f	Apr 12, 1898	14
	Mannie "	f	Apr 13, 1902	10
20. Mrs. J. T. TURNEY	Rovera TURNEY	f	May 15, 1893	19
	John "	m	Nov 5, 1896	16
21. Cleat PEATERSON	Paul PEATERSON	m	Dec 23, 1904	
22. G. W. STEVENSON	Opal STEVENSON	f	Dec 6, 1905	7
23. J. O. DOWDY	Lois DOWDY	f	Feb 11, 1905	7
24. G. M. DIWINE	Rubenta DIWINE	f	Jun 7, 1904	8
25. Tony BESHARA	Bennece BESHARA	f	Aug 10, 1904	8
26. Edd RITCHEY	Ray RITCHEY	f	Dec 19, 1903	10
27. G. F. BOWERS	Mettie BOWERS	f	Mar 2, 1900	12
	Wannen "	m	Apr 6, 1902	10
28. R. J. CARUTHERS	Mary CARUTHERS	f	Dec 16, 1905	7
29. C. B. CHURCH	Munnel CHURCH	m	Jul 15, 1898	14
	Glenn "	m	Feb 14, 1900	12
30. Chas VANHORN	Willie VANHORN	m	Feb 1, 1898	14
	Lina "	f	Sep 28, 1901	11
	Fred "	f	Oct 4, 1905	7
31. Ch. ROGERS	Flow Wallis		Nov 6, 1895	17

32.	J. C. SCULLY	Edith SCULLY	£	Jan 25, 1892	20
		Florence "	£	Feb 13, 1896	16
		Anna "	£	Jun 30, 1895	15
		Agnes "	£	Nov 14, 1901	11
		Hellen "	£	Jul 1, 1906	6
		Veronica "	£	Mar 25, 1896	16
33.	C. V. WILSON	Blanchard WILSON	m	Apr 29, 1902	10
34.	T. H. HARRIS	Daisie HARRIS	£	Jul 19, 1892	20
		Tedy "	m	Jun 25, 1898	14
35.	W. H. OSTERLOH	Alta OSTERLOH			
36.	J. R. ANTHONY	Robert ANTHONY	m	Oct 19, 1897	15
		Lizzie "	£	Jan 9, 1902	11
37.	S. E. WILSON	Frank WILSON	m	Feb 7, 1892	20
		Leslie "	m	Sep 19, 1897	15
38.	P. H. PEPPERKORN	Robert PEPPERKORN			
39.	J. E. McLAIN	Mildred McLAIN	£	Apr 27, 1904	8
40.	W. C. PLOG	Lelia PLOG	£	Feb 4, 1895	15
		Olva "	£	Aug 8, 1902	10
		Oda "	£	Sep 30, 1904	8
41.	B. McARTHUR	Junice McARTHUR	£	Mar 31, 1895	15
		Archie "	m	Mar 1899	13
42.	Charles CUNNINGHAM	Hughes CUNNINGHAM	m	Sep 8, 1901	11
43.	Thomas PETTIGREW	Bulah PETTIGREW	£	Jun 23, 1899	13
		Theodore "	m	Oct 29, 1901	11
		Cathrine "	£	Jul 3, 1905	7
44.	C. E. HENSON	Anna HENSON	£	Jun 19, 1895	16
		Tom "	m	Jan 1, 1897	15
45.	Joe INICHEN	Clara INICHEN	£	Jan 10, 1893	19
		Edna "	£	Oct 27, 1895	17
		Alma "	£	Apr 23, 1898	14
		Agnes "	£	Mar , 1900	12
		Henry "	m	Jun 23, 1903	9
46.	Albert CHOAT	Walter CHOAT	m	Sep 10, 1895	17
		Isac "	m	Apr 16, 1898	14
		Ora "	£	Sep 24, 1900	12
47.	W. F. HINDMAN	James HINDMAN	m	Mar 30, 1899	15
		Robert "	m	Sep 10, 1902	10
		Paul "	m	Jun 23, 1904	8

47. con't	Charles HINDMAN	m	Mar 11, 1905	7
	Gilbert "			
	Oda "			
48. (no name)	Bayard TAYLOR	m	Aug 30, 1902	10
	Hugh "	m	Nov 3, 1903	9
49. David German	Willie GERMAN	m	Aug 7, 1896	16
	Ray "	m	Oct 22, 1898	14
50. E. H. DUNLAP	Carl DUNLAP	m	Apr 2, 1898	14
	Earnest "	m	Dec 30, 1902	10
51. A. C. LONG	Alma LONG	f	Jun 28, 1904	8
52. T. J. WEAVER	Jack WEAVER	m	Mar 9, 1893	19
53. J. F. NICHOLS	Hazel NICHOLS	f	Sep 15, 1897	16
54. Gill BROWN	Leona BROWN	f	Mar 18, 1894	18
	Levis "	m	Aug 11, 1896	16
	Harold "	m	May 17, 1906	6
55. Lister GARMAND	Daisie GARMAND	f	oct 2, 1903	9
	Lister "	m	Jun 12, 1905	7
	George "	m	Sep 19, 1906	6
56. John MOSS	Bud MOSS	m	Mar 12. 1892	20
	Sam "	m	Dec 29, 1898	14
	Gannett "	m	Apr 14, 1900	12
57. C. PENEDERGHART	Catherine GOSS	f	Apr 21, 1902	10
	Earnest "	m	Feb 28, 1905	9
58. T. J. WAY	T. J. WAY Jr.	m	Jul 5, 1899	13
	George "	m	Nov 22, 1900	12
	Faith "	f	Jan 14, 1903	9
	Howard "	m	Nov 29, 1905	7
59. W. T. DAVIS	Elizabeth DAVIS	f	Jul 7, 1902	10
60. E. H. BEARD	Jim BEARD	m	May 16, 1892	20
	Tom "	m	Apr 29, 1894	18
	Ona "	f	May 27, 1897	15
	William "	M	Jul 14, 1900	12
	Clara "	f	Nov 27, 1903	9
	Oda "	f	Oct 20, 1905	7
61. Charley Greenhaw	Willie Greenhaw	m	Dec 20, 1895	19
	Roy "		Sep 3, 1897	15

62.	W. J. BROWN	Lotis BROWN	♀	Apr 27, 1898	14
		Elmer "	m	Mar 12, 1900	12
		Omega "	♀	Aug 14, 1905	7
63.	E. B. ANTHONY	Tom ANTHONY	m	Jan 18, 1892	20
64.	G. H. KAYLER	TheLma KAYLER	♀	Feb 11, 1900	12
		Vera "	♀	Jun 23, 1903	9
		Harvard "	m	Jun 3, 1906	6
		Ruby McGREW	F	Apr 23, 1895	17
65.	William SARTIN	Nona SARTIN	♀	Feb 19, 1894	18
		Bessie "	♀	Oct 20, 1899	15
66.	Oscar WILKINS	Nannie WILKINS	♀	Jan 15, 1899	15
67.	M. M. GRACE	Vincent GRACE	m	Feb 18, 1906	6
68.	J. A. ESKEW	Ina ESKEW	♀	Aug 28, 1896	16
		Elzie "	♀	Jul 9, 1891	20
69.	J. A. JACKSON	Iva JACKSON	♀	Mar 18, 1900	12
70.	J. D. DAILY	Suda DAILY	♀	Jan 15, 1894	18
		Doy "	m	Oct 28, 1899	15
		Osie "	♀	Jan 15, 1901	11
		Lonzo "	m	May 19, 1905	7
		Chester "	m		19
71.	W. E. CHAMBERS	Clarence CHAMBERS	m	May 12, 1902	9
		Edwin "	m	Jul 26, 1905	7
72.	Blank				
73.	D. J. REIDS	Daniel REIDS		Aug 10, 1905	7
74.	Will CARR	Lester HARRIS	m	Mar 5, 1904	8
75.	W. J. BAKER	Vergie BAKER	♀	Aug 8, 1896	15
		Flo "	♀	Jan 14, 1897	15
		Event "	m	Aug 7, 1900	12
		Ralf "	m	Jan 27, 1905	7
76.	Maud MORISTON	Lee MORISTON	m	Nov 24, 1906	6
77.	Thomas WRIGHT	Mary WRIGHT	♀	Apr 14, 1901	11
		Abe "	m	Jul 19, 1902	10
		Ponten "	m	Mar 31, 1904	8
78.	J. B. WRIGHT	Wilbenn FULTZ	m	Apr 13, 1902	10
		Willie "	m	Apr 16, 1903	9
		Delbert WRIGHT		Mar 1, 1905	7

79.	C. B. BERRY HILL	David BERRYHILL	m	Aug 4, 1892	20
		Hull "	m	Mar 27, 1893	19
		Albert "	m	Jul 30, 1893	17
		Daniel "	m	Mar 9, 1896	16
		C. D. "	m	Dec 6, 1897	15
		Ann "	♀	Oct 30, 1899	13
80.	con't from 79	Charles "	m	Apr 21, 1900	12
		Emma "	♀	Sep 24, 1903	9
		Faith "	♀	Aug 1905	7
81.	D. STOWELL	Milton STOWELL	m	Dec 10, 1904	8
82.	G. W. ROGERS	Oren ROGERS	m	Jun 25, 1903	9
		Lester "	m	Sep 8, 1905	7
83.	Henry WHEAT	Roses FURGISON	m	Jan 18, 1892	20
		Olen WHEAT	m	Feb 8, 1901	11
		Fennel "	m	Nov 20, 1904	8
84.	W. S. SATTERFIELD	Brady SATTERFIELD	m	Mar 30, 1905	9
85.	A. W. ADRIANSSENS	Vernon ADRIANSSENS	m	Jan 28, 1903	9
		Dottie "	♀	Jun 18, 1905	7
86.	J. A. COLE	Holland COLE	m	Aug 20, 1893	19
		Ruth "	♀	Sep 14, 1894	18
		Hurbert "	m	Jun 18, 1896	16
		Rupert "	m	Mar 14, 1898	14
		Raymond "		Jun 22, 1899	13
		Grace "		Jun 1905	7
87.	L. LEWIS	Lealand LEWIS	m	Apr 13, 1896	16
		Lily "	m	Oct 9, 1903	9
88.	(no name)	Frank BROWN	m	Jul 3, 1896	16
		Gertie "	♀	Oct 28, 1899	13
		Simon "	m	Oct 27, 1905	7
89.	J. PONEMAN	Bertha PONEMAN	♀	Dec 28, 1899	15
		Francis "	m	Jan 3, 1899	13
		Veneda "		Jul 30, 1905	7
90.	B. H. HATCHEL	Vernon HATCHEL	♀	Jul 31, 1897	15
		Benny "	m	Jul 8, 1901	11
		Charles "	m	Aug 17, 1904	8
91.	C. L. HENSON	Marvin HENSON	m	Jan 19, 1899	13
		Spanling "	m	Oct 5, 1901	11
		Ruby "	♀	Jun 16, 1904	8

92. A. O. ROBERTS	Evelyn ROBERTS	♀ Mar 19, 1906	6
93. Emma SMITH	Anthun SMITH	m Jan 29, 1893	19
	Anna "	♀ Nov 3, 1899	13
	Grace "	♀ Dec 22, 1901	11
	Tenny "	m Oct 29, 1904	8
94. L. EASTON	Vingil EASTON	m Feb 14, 1904	8
	Myrtle "	♀ May 19, 1905	7
95. J. H. JONES	Henny JONES	m Mar 1, 1897	15
	Olie "	m Dec 5, 1903	9
	Vergil "	m May 4, 1905	7
96. J. D. LOPP	Hellen LOPP	♀ Aug 19, 1904	8
	Oscar "	m Sep 17, 1905	7

J. W. BRADY DEPUTY CLERK SCHOOL DISTRICT 10
 15 Jan. 1912 BEN C. TAYLOR N. P. 13 Sep. 1913

Spelling of names and dates of births are as is in the census book.
 Also the sex of children are as in the census book.

White males	151	Colored males	74
W. females	<u>126</u>	C. females	<u>73</u>
TOTAL	277	TOTAL	147
TOTAL AGGREGATE 424			

#####

NEW MEMBERS

LEATHERMAN, FLOREHA, 2600 N. 74TH STREET, MUSKOGEE OK 74401.

EVANS, BESSIE, 808 OSAGE, MUSKOGEE OK 74403.

Researching: HUGHES, Robert JEFFERSON Muskogee Ok
 disappearance 1906--Ft. Gibson Ok.

 *
 * IN MEMORY OF *
 * EARL EARNEST BOGGS *
 * Jan. 24, 1923---Nov. 3, 1992 *
 * Husband of member -- LU LU BOGGS *
 *

Gnitts

The Gnitts community, sometimes called Gnitts Hill was settled shortly after Walter Webben came to La Cascade in 1829. La Cascade was named by the French, meaning 'Waters Falls'.

The Gnitts area was rich in resources. Pecan, Hickory, Black Walnut, Persimmon trees were in abundance. Wild game was plentiful. The soil was good for farming. Coal and salt was later found in the area.

In 1902 Gnitts had a population of 100 and had a daily stage and mail run to Webbens Falls.

The following businesses were there then.

A 'General Store - proprietor - Jesse Ross

Blacksmith shop - Franklin Gnitts.

Stock Connal - D.N. Carlisle.

Drugs & Groceries - Doctor E.E. Tabor and Son.

A Post office was there from March 21, 1896 to Oct. 30, 1909.

Inola NEFF, Guy Waters, Bettie Anderson and Steve Connsilk owned land adjacent to Gnitts.

In 1939 some of the old building still stood. M. Dyen lived in the old 'Stone' building. Other people who lived there in '39' are shown the 1939 map. Also shown is the location of the Gnitts cemetery.

Cleo Shamblin
1992

P.S.

I omitted the POSTMASTER - who
WAS ELIAS TABOR. (IN 1902)

Grid map showing location of Gritts and surrounding home owners

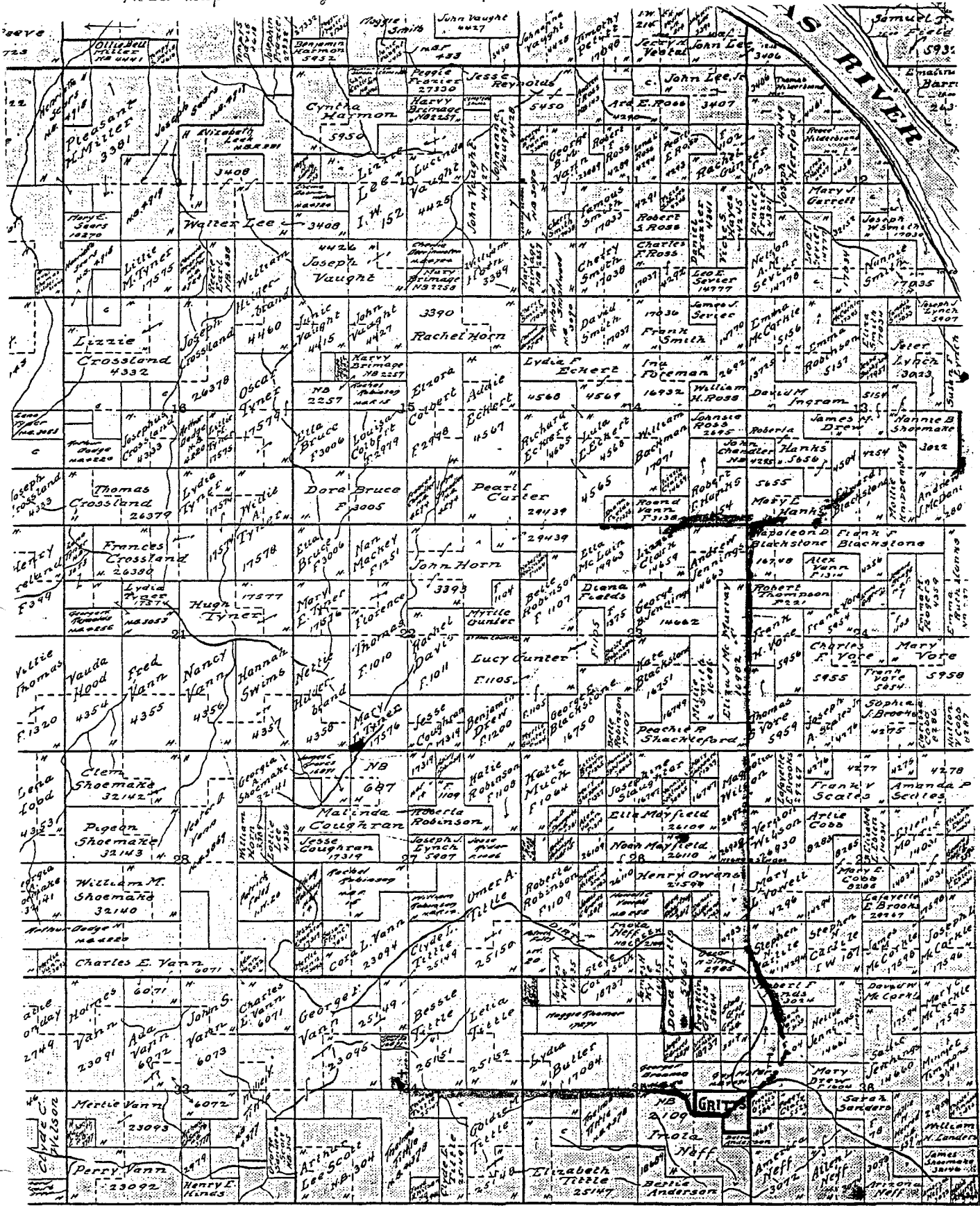

LAND OWNERS BEFORE 1910

MAP TO SHOW
RESIDENTS IN 1939
OF GRITTS

MAP is not to scale
INTERSTATE 40 and the TERRAPIN are added here
to show their proximity to old GRITTS

By
Area 4, Shamblin's

NEFP School

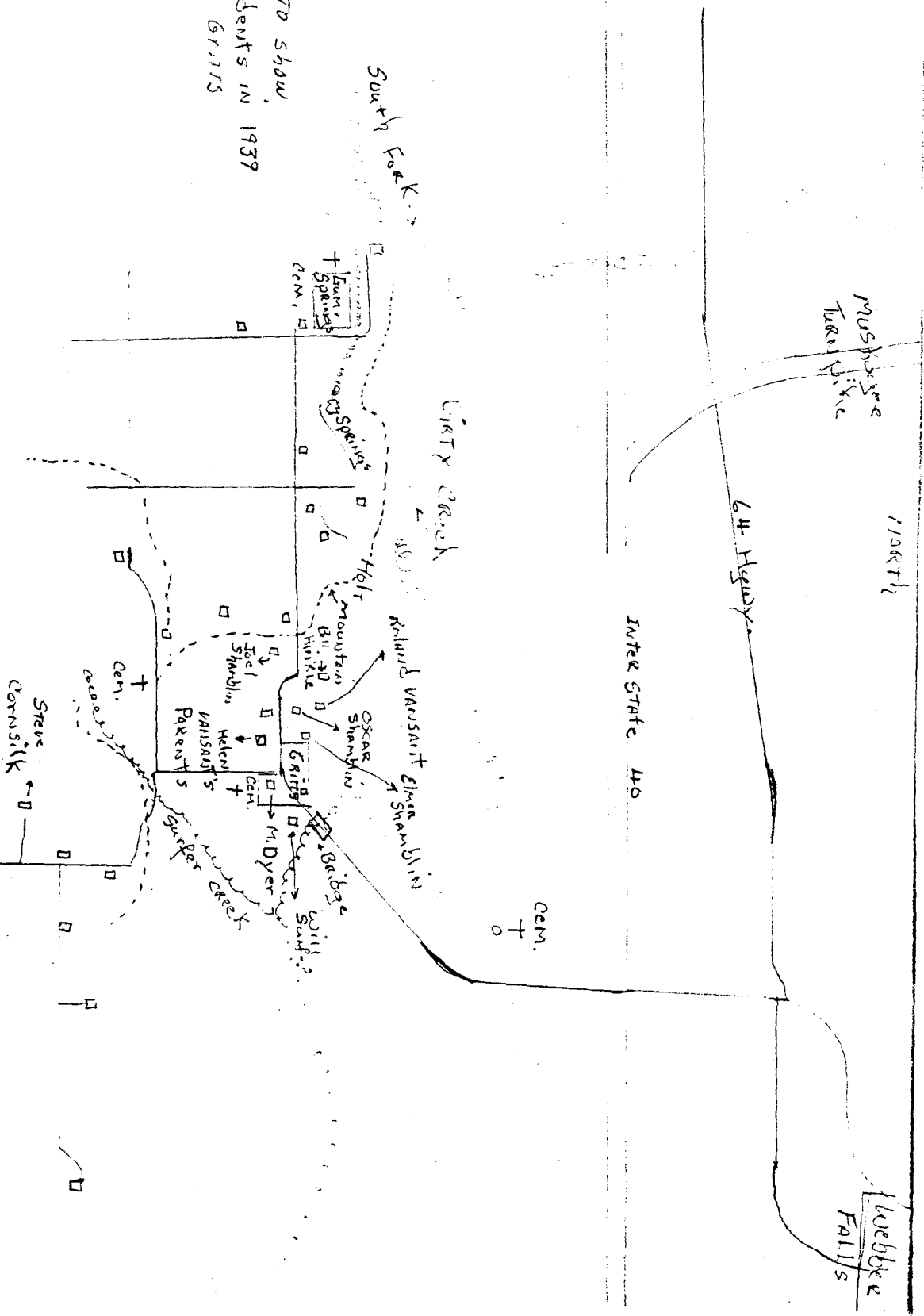

ACCIDENTAL DEATHS

THE FOLLOWING ARTICLES ARE OF ACCIDENTAL DEATHS WHICH ARE FOUND IN THE MUSKOGEE TIMES DEMOCRAT UNLESS OTHERWISE NOTED.

Name, Place, Date of Newspaper,
Page Number and Column are shown.

ANDERSON, Anna B. Guthrie 18 Jan 1910, p.1, c.2	DOYLE, Thomas L. Muskogee 12 Apr 1905, p.2, c.3-4
ANDERSON, Orbek 3 Feb 1916, p.1, c.4 4 Feb 1916, p.1, c.3	FINN, Patrick 21 Feb 1910, p.1, c.1
ATKINS, Isabelle Meagher 11 Jul 1912, p.1, c.5-7 (Daily Phoenix)	FREED, Sam El Reno 16 Jan 1908, p.5, c.4
BILBY, J.S. Catoosa 27 Nov 1919, p.2, c.4	GAMMEL, W.H. 29 Nov 1918, p.1, c.5
BIXBY, Bradford 25 Feb 1916, p.1, c.6	GOFORTH, W.B. Bengal 15 Nov 1909, p.2, c.6
BLOODWORTH, James Enid 8 June 1909, p.1, c.5-6	GUTHRIE, Dessa Elam Oktaha 12 Jun 1919, p.12, c.2
CAMP, Claude 11 Jun 1906, p.2, c.1-2	GUTHRIE, James Braggs 17 Aug 1907, p.2, c.2
COBB, H. 10 Feb 1909, p.1, c.5-7	HARE, Charles 13 Mar 1907, p.1, c.6-7
COCHRAN, Ned 8 Nov 1909, p.2, c.5	HARNBECK, S.G. 14 Sep 1910, p.1, c.6
COHENOUR, William Muskogee 1 Aug 1919, p.16, c.1	HINTON, Harry 22 Sep 1917, p.5, c.4
COPUS, J.A., Mrs. Muskogee 11 Jun 1906, p.1, c.1-4	HOUSE, Pearl Broken Arrow 24 Nov 1909, p.1, c.6
CORNETT, Dexter 16 Aug 1914, p.1, c.4	HYSON, Willie Bartlesville 15 Jan 1908, p.1, c.5
COUGHILL, Peter B. Muskogee 7 Feb 1910, p.10, c.6-7	JOHNSON, George O. (Senator) 10 Feb 1909, p.1, c.5-7
CRANE, B.H. 18 Jun 1914, p.1, c.1-3	JOHNSON, Leonard 3 Feb 1916, p.1, c.4 4 Feb 1916, p.1, c.3
CRITTENDEN, Fred 29 Nov 1917, p.1, c.2	KEELER, Charles E. Bartlesville 21 Apr 1909, p.1, c.5
DAVIS, Jim Muskogee 10 Mar 1920, p.1, c.7	MACK, Carl 28 Feb 1908, p.1, c.6
DODSON, son of W.T. Muskogee 12 Jul 1908, p.1, c.3	MARTIN, Charles 4 Jun 1917, p.1, c.1

MARTIN, Clarence 17 Feb 1908, p.2, c.5	RILEY, Frank Canadian 19 Feb 1910, p.8, c.2
MARTIN, son of Edwin 8 Dec 1911, p.1, c.4-5 8 Dec 1911, p.9, c.5	ROSS, Charles, Dr. Tahlequah 3 Nov 1908, p.2, c.4
MUNN, Drew Stigler 13 Jan 1908, p.6, c.3	RUTHERFORD, S. Morton 18 Dec 1922, p.1, c.2
PIKE, Frank H. Carthage, MO 28 Oct 1911, p.3, c.1-2	SCHMOYER, E.L. 9 Feb 1923, p.1, c.2
POSEY, Alex 28 May 1908, p.1, c.1 28 May 1908, p.6, c.4-5	SMITH, J.M. 6 Jul 1920, p.1, c.6
PURDUE, Louise 22 Mar 1918, p.8, c.3	SONDHEIMER, Alexander 25 Sep 1923, p.1, c.6 10 Oct 1923, p.1, c.5 10 Oct 1923, p.8, c.2-4
RAMAGE, J.R. 20 Sep 1910, p.1, c.1-2	STEINER, George 3 Feb 1916, p.1, c.4 4 Feb 1916, p.1, c.3
REDIC, Chester V. 28 Jul 1919, p.2, c.4	THOMPSON, Robert 14 Sep 1910, p.1, c.6
REESE, David 27 May 1907, p.5, c.1-2	WATKINS, George Tamaha 11 Jun 1908, p.1, c.5
REGALMAN, Edward 11 Nov 1909, p.4, c.2	WEEKLY, June Enid 8 Jun 1909, p.1, c.5-6
RICHARDS, Albert Muskogee 27 May 1920, p.12, c.1	WHITE, Warwick C. 11 Dec 1916, p.1, c.2

GROUP SEEKING BURIAL PLACES OF CIVIL WAR
VETERANS IN STATE

The Muskogee area is the current focus of a statewide effort to register the burial locations of Civil War veterans in Oklahoma.

A large number of Civil War veterans settled in the area and were active in several Civil War veteran's groups, but their burial locations are not known. Information on Union and Confederate veterans is being collected by the Sons of Confederate Veterans. It will be indexed on computer for use by anyone doing historical or genealogical research in libraries nationwide.

The organization has a special interest in finding the graves of Native and African Americans because most of their burial sites have not been registered.

The public is requested to give the name of the veteran, unit and state served, childrens' names, the birth and death dates of both veteran and wife, place of burial and address of current area descendants, if possible.

Please send the information to Deone K. Percy and N. Dale Talkington, 9 E. Janice #103, Yukon, OK 73099 or to Greg Moore, OK Civil War Registrations, P.O. Box 35851, Tulsa, OK 74153-0851.

Name of Compiler Nancy C. Goff
 Address 2727 N. Edmond
 City, State Muskogee, OK.
 Date 10/5/94

Ancestor Chart

Person No. 1 on this chart is the same person as No. 1 on chart No. 1

Chart No. _____

b. Date of Birth
 p.b. Place of Birth
 m. Date of Marriage
 d. Date of Death
 p.d. Place of Death

4 SAM A. Jones
 (Father of No. 2)
 b. 7-3, 1870
 p.b. Somewhere in MO.
 m.
 d. Oct. 7, 1955
 p.d. Ottawa, Mo.

2 Gilbert Jones
 (Father of No. 1)
 b. July 7, 1894
 p.b. Near Blue Eye, MO.
 m. # 12-9-1917 - # 10-10-93
 d. May 8, 1949
 p.d. Fairland, OK La.

5 Nettie Norris (Jones)
 (Mother of No. 2)
 b. 2-28-1872
 p.b. Kentucky
 d. August 22, 1934
 p.d.

1 Nancy Carol Jones (Goff)
 b. 3-4-40
 p.b. Fairland, OK.
 m. Sept. 24, 1960
 d.
 p.d.

8 Josiah White
 (Father of No. 3)
 b. 12-23-1859
 p.b. Near Branson MO field
 m. 1-18-1900
 d. 1-12-1936 or 1-14
 p.d. Fairland, OK. #33597
 allotment

3 Euna Laveda White (Jones)
 (Mother of No. 1)
 b. 6-4-1907
 p.b. Fairland, OK.
 d. 12-5-90
 p.d. Waldron, ARK.

7 Ida Ann Hampton White
 (Mother of No. 3)
 b. 1-17-1878
 p.b. Near Harrison, ARK. (Boone Co)
 d. 3-10-62
 p.d. Afton, OK

(Spouse of No. 1)
 b. _____
 p.b. _____
 d. _____
 p.d. _____

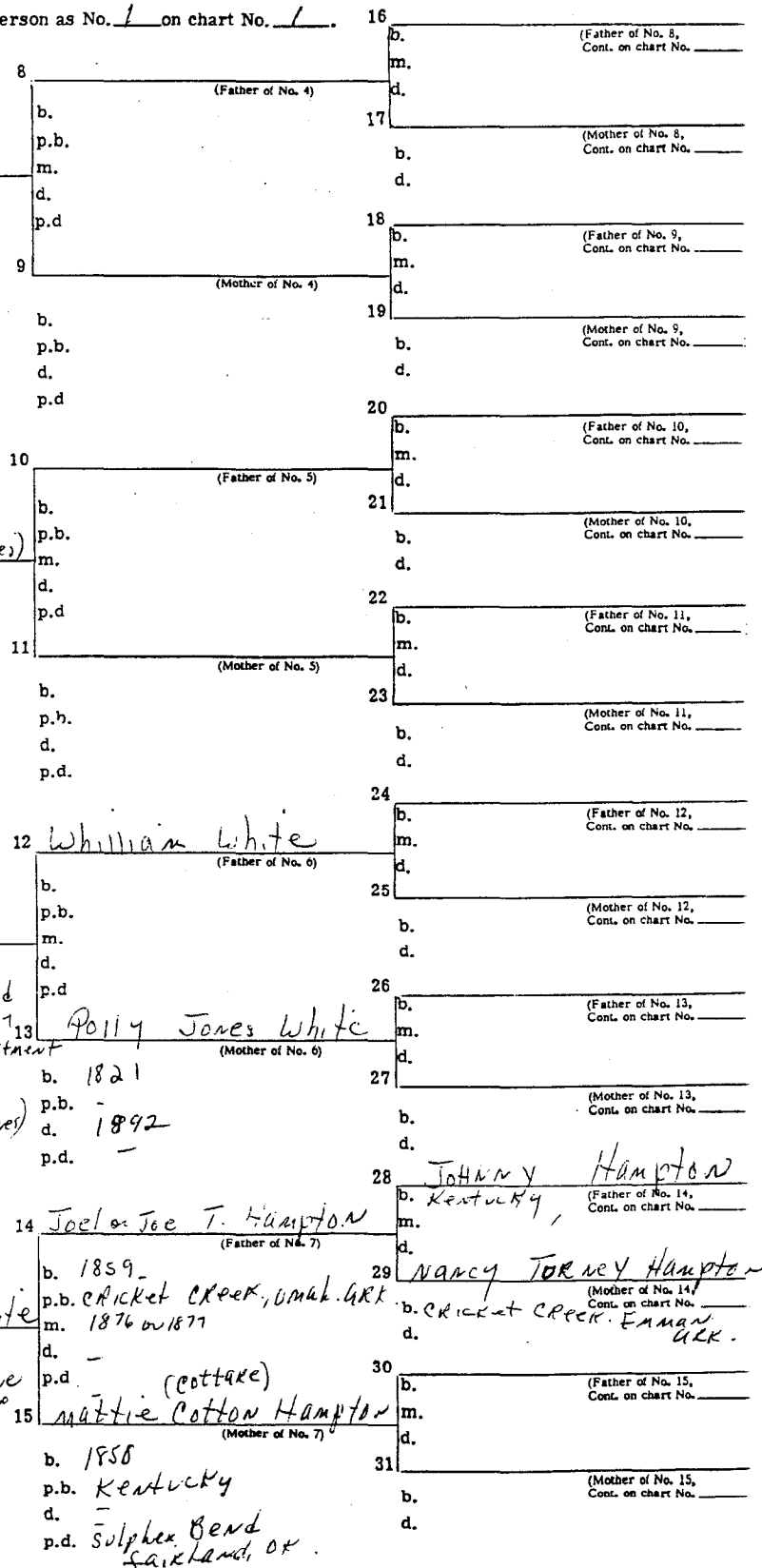

Form A2. Copyright 1983 by The Everton Publishers, Inc., P.O. Box 368, Logan, Utah, publishers of THE GENERALOGICAL HELPER. Send for a free catalogue with lists and full descriptions of many genealogical aids.

Date Recopied 2 Feb, 1981

ANCESTOR CHART NO. _____

Name of compiler Barbara Drake Ritter



City _____
 Person No. 1 on d _____
 on chart No. _____

b Date of birth
 b Place of birth
 m Date of marriage
 d Date of death
 pd Place of death

1 CHARLES EUGENE DRAKE SR.
 b 19 Jan 1914
 m Leon Butler KS
 d 22 June, 1984
 pd Great Bend Barton KS

2 BARBARA JO DRAKE
 b 13 April 1933
 m Tulsa Tulsa OK
 d 30 Sept. 1951
 pd

3 m. Lugene Charles Ritter
 b. 22 Jan, 1928
 pb. Tribune Greeley KS
 4 JUANITA LILLARD BAUGHMAN
 b 25 Jan 1913
 m Checotah McIntosh OK
 d

5 EDWARD EASTMAN DRAKE
 b 25 Feb 1886
 m Princeton Gibson IN
 d 25 June 1909
 pd 24 April, 1944
 Tulsa OK

6 GERTRUDE ELIZABETH BAIRD
 b 19 Oct. 1893
 m Winfield Cowley KS
 d 9 Jan. 1989
 pd Grand Junction Mesa CO

7 EZRA LYTLE BAUGHMAN
 b 27 Feb 1889
 m Harrison Boone AK
 d June 1951
 Napa CA

8 WILLIE GEORGIA (BENSON)
 CHAPMAN
 b ca. 20 Sept. 1882 MISS
 m Columbus Lowndes
 d 11 Oct. 1971
 pd San Pablo Contra Costa CA

9 JAMES ALBERT DRAKE
 b 27 Jan 1861
 m Linden Mont. IN
 d 15 March 1884
 pd Topeka Shawnee KS

10 ORA BELLE MCNEELY
 b 6 March 1867
 m Hosmer Pike IN
 d 5 Dec. 1912
 pd Davenport Scott Iowa

11 JOHN BELL BAIRD
 b 13 Nov. 1860
 m River Top, Lawrence MO
 d 24 Dec. 1876
 pd Theodesha Wilson KS
 JANE ARTEMUS WALLIS
 b 18 April 1861
 pd

12 ISSAC NICHOLAS BAUGHMAN
 b 19 Oct. 1854
 m Old Carroll Co. ARK
 d 17 April 1895
 m Checotah McIntosh OK

13 PARADINE RIDENR-RIDENGER
 b Harrison Boone ARK
 pd

14 WILLIAM BENSON
 b 20 Sept. 1881 ?
 m ca 1884 ?
 pd
 m MS
 m WILLIAM BROWN ??
 (Mother of No. 7)
 (Mother of No. 7)
 ca 1882 ?

16 WILLIAM F. DRAKE
 b. ca 1829
 pb. Warren Co. Ohio
 LAURA C. PARKER
 (Mother of No. 8)
 Continued on chart

18 DAVID MCNEELY
 b. 10 March 1833
 pb. Spencer Co. IN
 NANCY MARIA PHILLIPS
 b. ca. 1844
 JOSIAH M. BAIRD
 (Father of No. 10)
 Continued on chart

20 JANE MOORE
 (Mother of No. 10)
 Continued on chart
 21 WILLIAM JASPER WALLIS
 (Father of No. 11)
 Continued on chart
 22 ELIZA KIMBELL
 (Mother of No. 11)
 Continued on chart

24 LEWIS LAFALETTE BAUGHMAN
 b. 16 Jan 1832
 ELENDRA LUZINA MITAM
 b. 18 Aug 1838
 GEORGE W. RIDENGER
 (Father of No. 13)
 Continued on chart
 SARAH KENNELLY
 (Mother of No. 13)
 Continued on chart

26
 (Father of No. 14)
 Continued on chart
 28
 (Mother of No. 14)
 Continued on chart
 30
 (Father of No. 15)
 Continued on chart
 31
 (Mother of No. 15)
 Continued on chart

Refer to name and number

NEW TITLES
in the
Grant Foreman Room
Muskogee Public Library

Alabama 1830 Census Index, donated by the Society
Georgia 1840 Census Index, donated by the Society
Tennessee 1840 Census Index, donated by the Society
Alabama 1850 Census Index, donated by the Society
Georgia 1850 Census Index, donated by the Society
Tennessee 1850 Census Index, donated by the Society
Family Records of the Colters and Culbertsons, by James P. Colter,
1889.
Stigler Cemetery, by Roger Baker, [1988]. Donated by Pauline King,
Stigler Chamber of Commerce.
Cemeteries of Muskogee County, Oklahoma, vol. II, by Deone & Walter
Penguite, 1992.
Boynton Index [Newspaper], 2 rolls microfilm. Donated by Norma N.
Jewell Tracy and Lillie Hodge Wiedel.

Genealogy Books
donated by
Myra Vanderpool Gormley
and the
Muskogee County Genealogical Society

The Pension Roll of 1835, 4 vols.
The Cape Cod Library of Local History and Genealogy, by Leonard H.
Smith, Jr., 2 vols.
Annals and Antiquities of the Counties and County Families of
Wales, by Thomas Nicholas, 2 vols.
Genealogical Records in Texas, by Imogene Kinard Kennedy and J.
Leon Kennedy.
English Origins of American Colonists, by Henry B. Hoff.
Owner Unknown, by J. D. Segel.
Saints and Sinners at Jersey Settlement, by Garland A. Hendricks.
Scottish-American Court Records 1733-1783, by David Dobson.
A Guide to Tracing Your Kerry Ancestors, by Michael H. O'Connor.
Vital Records of Hampton, New Hampshire, vol. 1, by George Freeman
Sanborn Jr. and Melinde Lutz Sanborn.
Zachary Taylor French and Rachel Evelyn Duckworth, by Gene Lawrence
Jackson.
Index to Pennsylvania's Colonial Records Series, comp. by Dr. Mary
Dunn.

Vital Records of Swansea, Massachusetts to 1850, trans. by H. L. Peter Rounds.

The Shane Manuscript Collection, a Genealogical Guide to the Kentucky and Ohio Papers, by William K. Hall.

Emigrants in Chains, by Peter Wilson Coldham.

Indexes to Seven State Census Reports for Counties in Georgia 1838-1845, comp. by Brigid S. Townsend.

Anglo-Americans in Spanish Archives, by Lawrence H. Feldman.

Abstracts of Georgia Colonial Book J 1755-1762, comp. by George Fuller Walker.

First American Jewish Families, comp. by Malcolm H. Stern.

Genealogical Research Directory, 1988, by Keith A. Johnson & Malcolm R. Sainty.

Prominent Families of the United States of America, by Arthur Meredyth Burke.

The Scotch-Irish of Colonial Pennsylvania, by Wayland F. Dunaway.

The Origin of Certain Place Names in the United States, 2nd ed., by Henry Gannett.

The Search for Missing Friends, vol. II: 1851-1853, ed. by Ruth-Ann M. Harris and B. Emer O'Keeffe.

The Genealogist's Address Book, by Elizabeth Petty Bentley.

The Complete Book of Emigrants 1700-1750, by Peter Wilson Coldham.

A Bibliography of Military Name Lists from Pre-1675 to 1900: A Guide to Genealogical Sources, by Lois Horowitz.

Royalty for Commoners, 2nd ed., by Roderick W. Stuart.

Dictionary of American Immigration History, ed. by Francesco Cordasco.

Genealogies of West Virginia Families, from The West Virginia Historical Magazine Quarterly, 1901-1905.

The A-Z Guide to Tracing Ancestors in Britain, by F. C. Markwell and Pauline Saul.

Emigrants from Ireland to America 1735-1743, by Frances McDonnell.

Virginia Counties: Those Resulting from Virginia Legislation, by Morgan Poitiaux Robinson.

Florida's First Families, by Donna Rachal Mills.

Supplement to the Complete Book of Emigrants in Bondage 1614-1775, by Peter Wilson Coldham.

North Carolina Wills: A Testator Index, 1665-1900, by Thornton W. Mitchell. 2 vols.

Nova Scotia Immigrants to 1867, comp. by Col. Leonard H. Smith, Jr.

United States Local Histories in the Library of Congress A Bibliography, ed. by Marion J. Kaminkow. 5 vols.

Origins of Pierce County Place Names, by Gary Fuller Reese.

A Guide to South Carolina Genealogical Research and Records, by Brent Howard Holcomb.

Albemarle County Marriages, 1780-1853, by John Vogt and T. William Kethley, Jr. 3 vols.

Greenbrier County Marriages, 1782-1900, by Larry G. Shuck. 3 vols.

Virginia Postmasters and Post Offices 1789-1832, by Edith F. Axelson.

Index to the Tithables of Loudoun County, Virginia and to Slaveholders and Slaves 1758-1786, comp. by Margaret Lail Hopkins.

Where Once We Walked, by Gary Mokotoff and Sallyann Amdur Sack.

PUBLICATIONS FOR SALE
MUSKOGEE COUNTY GENEALOGICAL SOCIETY

<u>CEMETERIES OF MUSKOGEE COUNTY, OKLAHOMA. VOL. I</u>	\$11.50 ppd.
Includes Agency, Bemo, Boynton, Brewer, Briartown, Brushy Mountain, Butler Creek, Council Hill, Doyle, Ft. Gibson/Anderson Bottom, Frozen Rock, Graves, Grayson, Plainview, Rock Grove, Starnes, Starr, Taylor, Walker, 2 Unidentified. 155 pages including index. Softbound.	
<u>CEMETERIES OF MUSKOGEE COUNTY, OKLAHOMA. VOL. II</u> ...	25.00 ppd.
Includes Harnage, Harris, Harris Family, Haskell, Jennings, Jobe Family, McClure, Middleton Chapel, Oktaha Community, Park, South Bethel, Summitt, 1 Un-named. 291 pages including index. Softbound.	
<u>MARRIAGE RECORDS, MUSKOGEE INDIAN TERRITORY, FIRST U.S. COURT - NORTHERN DISTRICT. BOOKS A, B and B-1, July 1890-March 1893.</u>	11.00 ppd.
108 pages including index. Softbound. Mickey Hagan and Rae Lindsey.	
<u>GENEALOGICAL DATA extracted from MUSKOGEE WEEKLY PHOENIX, INDIAN TERRITORY 1888-1892</u>	7.00 ppd.
56 pages including index. Softbound.	
<u>GENEALOGICAL DATA extracted from MUSKOGEE WEEKLY PHOENIX, INDIAN TERRITORY 1893-1897. VOL II</u>	8.00 ppd.
57 pages including index. Softbound.	
<u>GENEALOGICAL DATA extracted from MUSKOGEE WEEKLY PHOENIX, INDIAN TERRITORY 1898-1902. VOL III</u>	9.00 ppd.
65 pages including index. Softbound.	
<u>INDEX OF DEATHS extracted from MUSKOGEE DAILY PHOENIX. January 16, 1930 - May 4, 1935</u>	5.00 ppd.
48 pages in alphabetical order. Softbound. (If a listing is found of an obituary, a photocopy may be ordered for a \$2.00 fee.)	
<u>TIPS ON CHEROKEE INDIAN RESEARCH</u>	1.50 ppd.
6 Leaves.	
<u>TABLE OF CONTENTS - MUSKOGEE COUNTY GENEALOGICAL SOCIETY QUARTERLIES. VOLUMES 1-8</u>	2.00 ppd.
<u>MUSKOGEE COUNTY GENEALOGICAL SOCIETY QUARTERY,</u> Back issues, per quarterly.....	3.00 ppd

ORDER FROM

MUSKOGEE COUNTY GENEALOGICAL SOCIETY, 801 W. OKMULGEE, MUSKOGEE, OK 74401

IMPORTANT RENEWAL NOTICE

IT'S TIME

\$8.00
Individual
Membership

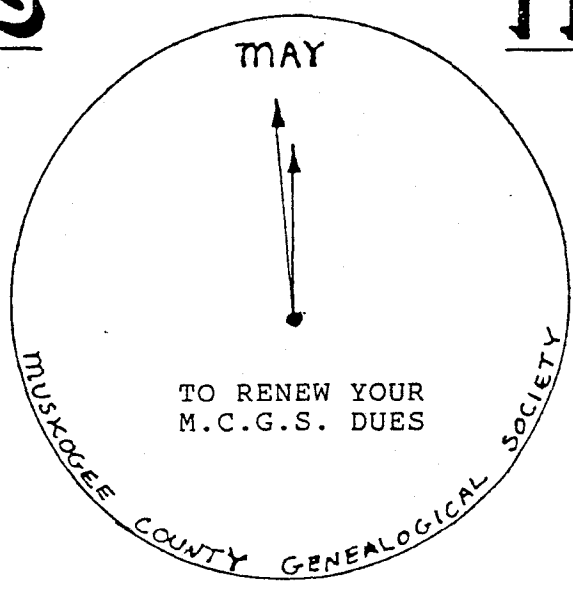

\$9.30
Family
Membership

The membership year for the Muskogee County Genealogical Society is being changed to the calendar year, January 1993 to January 1994.

In order to make this change, the dues will be pro-rated to fit the new schedule.

Due in May. Single Memberships will be \$8.00 and Family Memberships will be \$9.30. (May through December)

Please submit your 1993 dues now, so that you will receive your 1993 June Quarterly, VOL. X, #1.

MEMBERSHIP RENEWAL - 1993

NAME _____ DATE _____

ADDRESS _____

TELEPHONE _____ City _____ State _____ Zip _____
_____ Renewal _____ New

_____ \$8.00 Individual _____ \$9.30 Family

This payment will be for membership up to January 1994. Quarterlies in June, September and December 1993.

Send check to the Muskogee County Genealogical Society, 801 West Okmulgee, Muskogee, OK 74401.